



Vintage Collectibles & Hawaiiiana Show

The Spring Wiki Wiki One Day Vintage Collectibles & Hawaiiiana Show is a one day **Invitational** tabletop show which will be held in the Neal Blaisdell Center Exhibition Hall on Sunday, **March 20, 2022**. Because of the pandemic, the show was moved from the Hawaii Suites to the larger Exhibition Hall to allow for more social distancing and greater air circulation.

All Wiki Wiki One Day Vintage Collectibles & Hawaiiiana Shows feature **NO VENDOR PRESALES** until Early Entry at 10am. All items sold must be at least 20 years old or older. Regular **SHOW HOURS** are from 11am to 5pm. Due to the corona virus pandemic, **anyone entering the Hall must wear a mask at all times.**

SHOW RULES- March 2022

Invitational

The Wiki Wiki One Day Vintage Collectibles & Hawaiiiana Show is a table top invitational show produced by Ilene & Wayne Productions, Inc. hereafter referred to as Management.

Management has the right to screen all applicants and has the final say regarding acceptance into the show and table placement.

Vaccination Policy

All vendors and helpers must show proof of being **FULLY** vaccinated or proof of having a negative PCR covid test result taken within 72 hours of the show. Please attach a copy of your vaccine card, along with those of all others on your badge list, when you send in your contract.

People are considered fully vaccinated **2 weeks after their second dose in a 2-dose series, such as the Pfizer or Moderna vaccines, or 2 weeks after a single-dose vaccine, such as Johnson & Johnson's Janssen vaccine.** Booster shots are fine too.

If you do not meet these requirements, regardless of your age, you are **NOT** vaccinated and will not be allowed in the show unless you have proof of a negative covid test as stated above.

No Pre-Sales

No buying or selling until 10am. If you finish setting up before then, you may either wait within your table space or go outside. Please refrain from looking and/or touching other people's items. 'Holding things' for other vendors is not allowed.

Early Entry & Early Sales

Vendors can start buying and selling at 10am, when the early entry customers come in. The setup will continue until 11am when the show officially starts.

What Can Be Sold?

The Wiki Wiki One Day Vintage Collectibles & Hawaiiiana Show is a 20 years & older collectibles table show. Any collectible or antique item that is at least 20 years old or older can be sold in the show. All items newer than 20 years old will be removed.

No Food or Drinks in Hall

Food will not be served in the Hall. **Masks must be worn at all times.** No eating or drinking in the hall. Tables will be set up outside. Bring your own food to eat outside.

Setup-Takedown

Setup hours are from 8am - 11am. Takedown hours are from 5pm - 7pm. Please do not take down before 5pm.

Badges

Badges will be given out once vaccination status has been verified. Vendors must include and send in copies of vaccination cards from all co-vendors and children(if applicable) with their contracts. Each table comes with 2 show badges, which will be given out at 7:30am.

If you, your co-vendor, or your child are not vaccinated, please show proof of a negative covid test result inside the glass doors near the vendor's loading area #1 when they pick up their badges. (see map).

A \$10 fee will be charged for each badge change made on show day. To avoid this fee, please submit your badge changes BEFORE the show.

Loading & Unloading

You may park your cars temporarily in the back of the Exhibition Hall for loading/unloading. You must move your cars when done unloading. The parking building is also available.

There are two vendor entrances into the hall. Please enter the hall from either the glass doors opposite the Concert Hall (loading entry #1) or the glass doors on the Diamond Head side of the Hall opposite the parking building (loading entry #2). Pick up your badges **FIRST** from Entrance #1 (see map). **CALL US IN ADVANCE IF YOU NEED SPECIAL ASSISTANCE.** We will not be using the large sliding doors.

Tables & Surroundings

Tables are 8 ft long by 30 inches wide and come with 2 chairs. The smallest table space is 8 ft. x 8 ft. including the table. **Please do not set up anything beyond your allotted space.**

There are a limited number of 2-table corner spaces available. These corners are sold as one unit. Please refrain from bringing items that pose a fire hazard to the room and public. Bring your own tablecloths.

Carts

No unescorted carts or handtrucks after 10am. Setup is until 11am. If you need to use any cart (even your own) after 10am, please see us for a cart escort (Blaisdell rules). The Blaisdell Center has a few carts available for vendor use and will be loaned out after 7:30am. Bring your own cart for less stress.

Vendor Responsibilities

Vendors & Juniors(if applicable) must be fully vaccinated or be able to show proof of a negative covid test result taken within 72 hours of the show or they will not be allowed in the show.

Vendor & Juniors must wear a mask at all times and practice social distancing when possible. Please bring hand sanitizers for your customers to use.

Vendor is responsible for finding out about and complying with all City & County of Honolulu, State of Hawaii, & Federal rules and laws regarding taxes, licensing, contraband, fire, safety, and health.

Premature takedown of your table or misuse of vendor badges may result in your being ineligible for future shows. All tables must be manned during show hours. Vendors are responsible for the security of their merchandise at all times including set-up and takedown. Management will not be responsible for any claims due to theft or damage.

Tables may be shared but no more additional badges will be issued. **It is the responsibility of the principle vendor to see that his sharing partner, and all badge wearers in his table, are aware of, understand, and abide by all rules governing the show.** Subleasing of tables is not allowed in this show.

Please do not engage in behavior that would interfere with your neighbor's sales or concentration.

Contract Default

Management shall have the right to terminate this agreement without having first to give notice or warning to a vendor and to immediately remove any vendor, along with his/her equipment, who violates the rules of the show.

If vendor defaults under any of the terms herein, management shall be free to re-let the respective rental space to a third party. If said rental space is resold, management may retain any and all payments on said rental space made by defaulting vendor.

Show Cancellation

Should the Neal Blaisdell Center become, in the sole judgment of the management, unfit for occupancy, or should the show be materially interfered with by reason of, including but not limited to, public health concerns, strike, war, natural disasters, injunction, fire, or any act beyond the control of the management, the Contract of Exhibit Space may be terminated. In that event, management will not incur any liability to refund vendor's table fee or for damages sustained by the vendor as a result of such termination.

In the event of such termination, the vendor expressly waives such liability and releases Ilene and Wayne Productions, Inc. of and from all claims for damages.

Contact Information

I&W Prod. Ph/fax: (808)941-9754 Cell: 561-1083 Email: wikiwiki@ukulele.com website: www.ukulele.com/wikiwiki.html

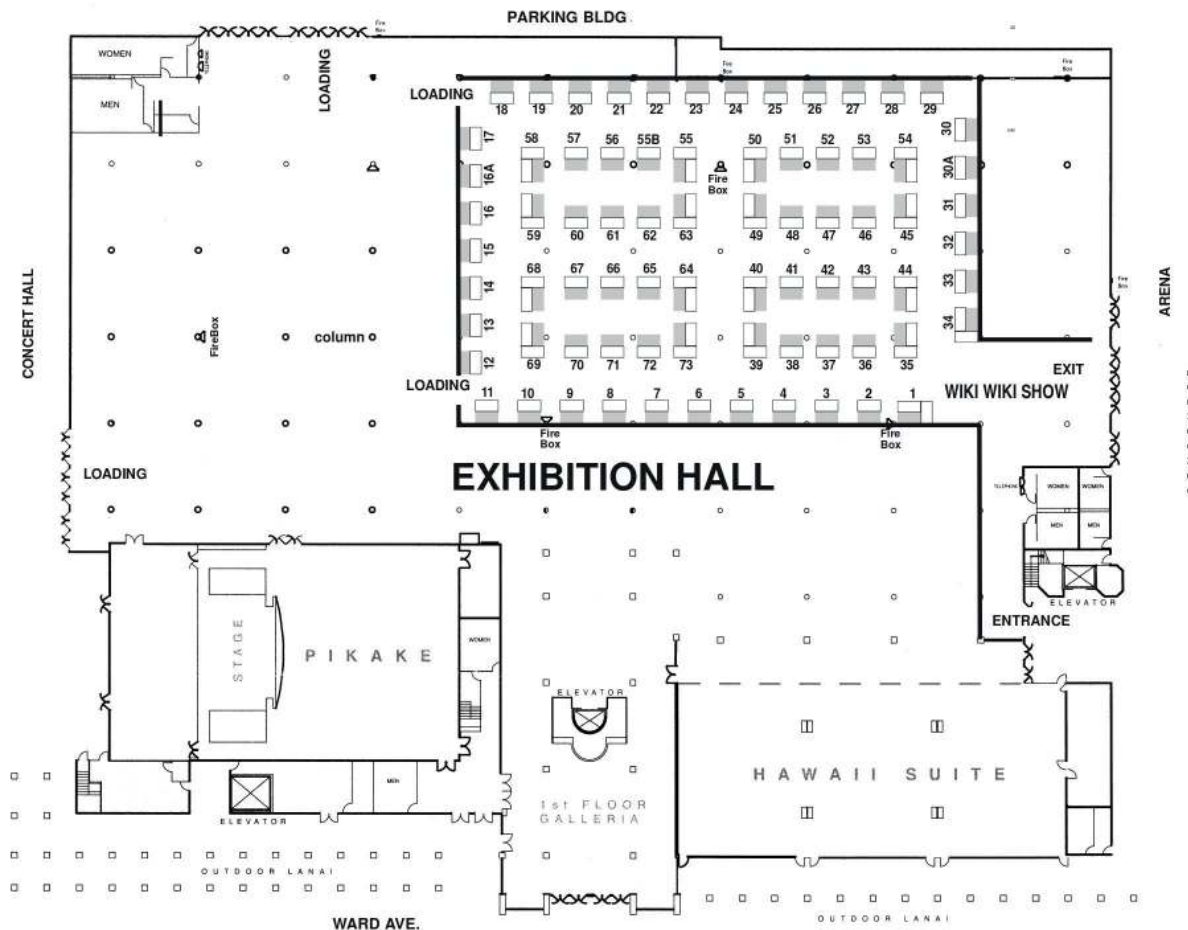

SPRING 2022 WIKI WIKI SHOW MAP & PRICES

This year's spring show will be held in the Blaisdell Center Exhibition Hall instead of the tiny Hawaii Suites. All tables and spaces will be the same sizes as before. Black dots in the map below represent concrete columns (30ft. apart). Please call for table availability.

Table Prices

Single Table

The stall is approx. 8ft x 8ft. Comes with 1 table and 2 chairs. Table size is 8ft. x30in.



\$175

Corner Tables

The stall is approx. 8ft x 10-1/2ft. Comes with 2 tables and 2 chairs. Tables are 8ft.x30in. in size.



\$340

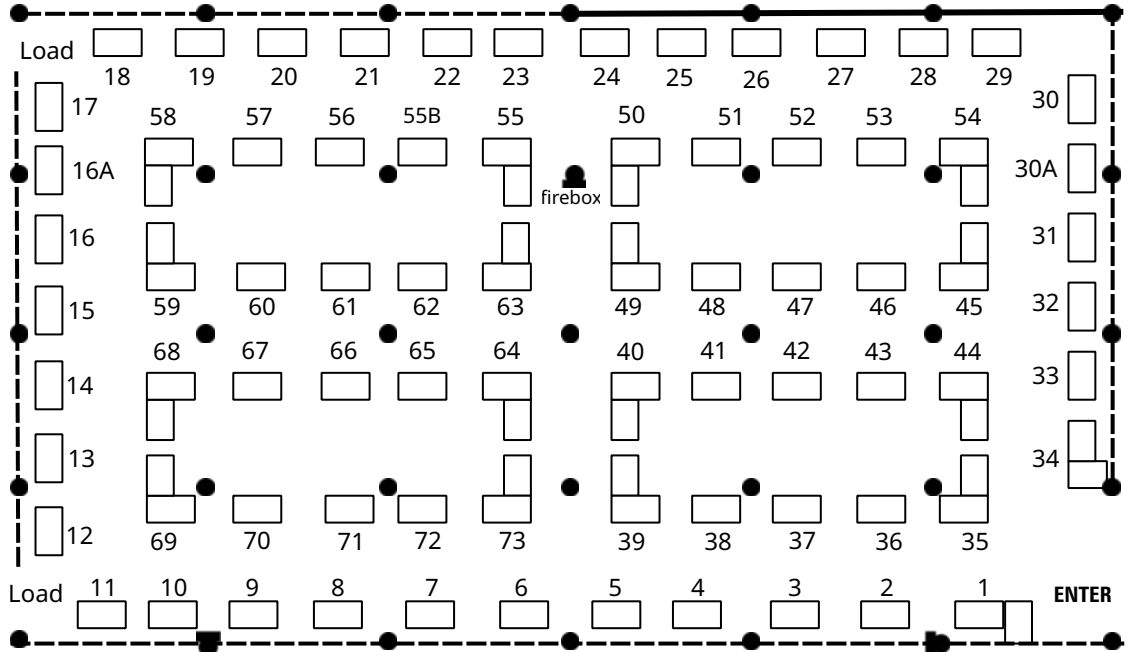

Exhibition Hall

How to Pay

We accept credit card payments directly or through PayPal. To pay directly, please call us. To use PayPal, email your payment to wikiwiki@ukulele.com. Don't forget to include your table number.

We also take checks. Make checks payable to Ilene & Wayne Productions.

Be sure to include a copy of your vaccination card (your co-vendors cards also).

You may also email it to us.

Ilene & Wayne Prod., Inc.

P.O. Box 61704

Honolulu, HI 96839

ph. (808) 941-9754

wikiwiki@ukulele.com

Show Advertising Options

If you would like to place an ad in the Spring 2022 Wiki Wiki One Day Show printed directory, website, and/or mailing list, please fill out the info below, clip out & include it and payment with your contract and camera ready artwork by March 5. Ads will be taken on a first come first served basis, space permitting.

If you need help designing your ad, contact us or include a sketch of your ad in the actual size box here.

Name _____ Table# _____

\$30- Run in show's printed directory & website. Directory ad is approx. 2.45in x 1.25in

\$60- Run on show's 1400 postcard direct mail mailing list. (Ad is approx 2in x 1in)

Amount enclosed _____

Table Top Coin Case Rental

You can rent a table top coin case for \$22 each. Case dimensions are 34in x 24in x 3in. Rentals are courtesy of the Hawaii State Numismatic Assn. These Allstate aluminum cases come with lock and key.

Lost keys incur a \$5 replacement fee.

Table# _____ Cases needed _____

Amount enclosed _____

Order deadline is March 10.

Please do not include this in the cost of your table. Please make a separate check out to HSNA, attach it to this form, and submit it with your show contract.

Attach check here

2022 SPRING WIKI WIKI CONTRACT

Name (Please Print) _____

Table (Business) Name _____

Address _____

City _____ State _____ Zip _____

Phone _____ Email _____

SHARING PARTNER (IF ANY)

It is the responsibility of the principle vendor to see that the sharing partner is aware of, understands, and will abide by all rules and guidelines governing the show.

Name _____ phone _____

Badge Names

Please list the names of you & your co-vendors. 2 badges per table. If you need to make changes, please do so BEFORE the show. Changes made at the show will cost \$10 each.

First table 1- _____ 2- _____

2nd table 1- _____ 2- _____

3rd table 1- _____ 2- _____

Junior 1- _____ 2- _____

Loading badges must be approved by the management. Junior badges are for vendors' minor children.

Items for Sale

Please list items that you will be selling in the order of importance.

1 _____

2 _____

3 _____

4 _____

5 _____

6 _____

7 _____

8 _____

9 _____

10 _____

AGREEMENT

Ilene & Wayne Productions, Inc. and its staff members, sub-contractors, employees, Neal Blaisdell Center, and the City & County of Honolulu assume no risk; and by acceptance of this agreement, the Vendor expressly releases Ilene & Wayne Productions, Inc., the Neal Blaisdell Center, and the City & County of Honolulu of and from any and all liability for any damage, injury or loss to any persons or property which may arise from the use of the Neal Blaisdell Center by vendor or his agent, or employees or to their property or wares and agrees to hold and save Ilene and Wayne Productions, Inc., Neal Blaisdell Center, and the City & County of Honolulu harmless of and from any loss or damage by reason thereof. Ilene and Wayne Productions, Inc., Neal Blaisdell Center, and the City & County of Honolulu assume no responsibility whatsoever for any property placed in the March 20 Spring Wiki Wiki Show, and each of them is hereby expressly released and discharged from any and all liability from any property loss.

I have been provided and have thoroughly read the Spring Wiki Wiki Show rules and agree to abide by them fully. I will use only safely constructed display equipment and booth furniture and will assume full responsibility should they accidentally injure persons and/or property and/or vehicles at this show.

I understand the NO PRESALE policy and I will not buy or sell anything before 10am.

I promise not to clear and/or take down my table until the end of the show at 5pm.

Vendor's Signature _____

Date _____

Sharing Partner(if any) _____

Date _____

Show Producer _____

Date _____

For office use

Table#

Confirm#

Table Choices (see map)

I'm interested in table # _____.

Please call/email to verify table selection.

Cost of table(s) plus tax: _____

I want to buy an Ad: _____

Total Amount Enclosed _____

Free Flyers, etc.

Use this material to inform your customers about the upcoming show. It's a good way to spread the word. It's free!

Please send me (how many of each?)

_____ postcards _____ flyers _____ posters

Send contract to: Ilene & Wayne Prod., Inc.
P.O. Box 61704
Honolulu, HI 96839
show@ukulele.com

2022 Spring Wiki Wiki Show Setup Map

Setup hours: 8:00am-11am.

Early entry: 10am.

Takedown hours: 5-7pm

Regular Show Hours: 11am- 5pm

Neal Blaisdell Center

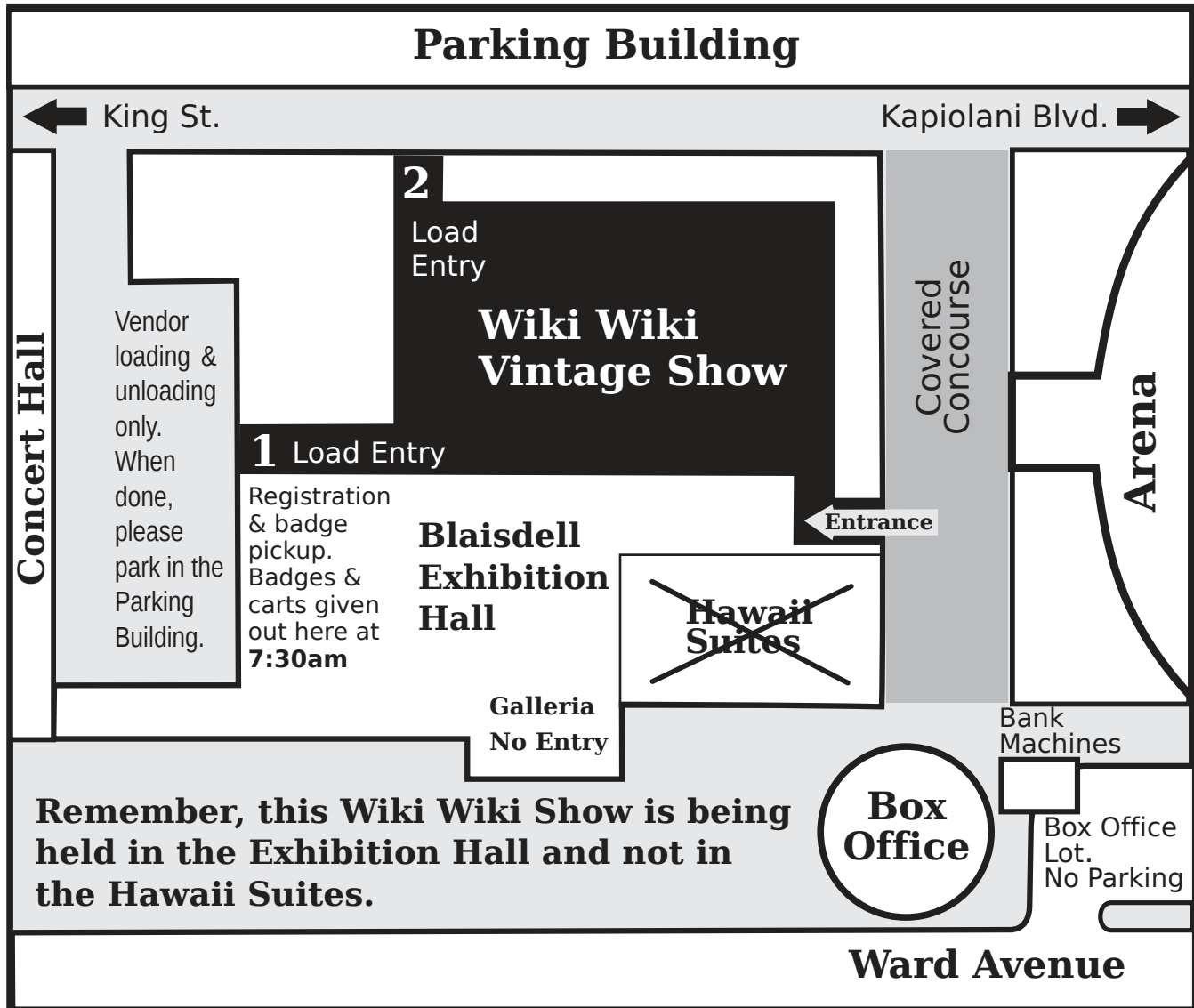

Exhibition Hall Show Setup Guide

1. TO UNLOAD, park your car either in the parking building or in the vendor's loading area (see map). Parking is NOT ALLOWED in the Box Office parking lot. Your car will be towed.
2. Pick up your badge at the rear entrance (loading entry #1) to the Exhibition Hall, inside the glass doors starting at 7:30am(see map). You can borrow one of 5 carts here on a first come first served basis. Don't forget to bring your ID. Do not load from the Galleria. That entrance is not available to us.
3. Start unloading your car. Show setup hours are from 8:00am to 11am.
4. After unloading, please move your car and park it in the Blaisdell's parking lot or building. Parking lot entrance is on King Street and costs \$8. Exhibitor's pass with in/out privileges costs \$10. You must pay for it upon entrance into the lot.
5. Do not come too early. We will not start the setup until 8:00am.

Visit our website at www.ukulele.com/wikiwiki.html